

4-LEGGED TUBE STAND MANUAL



YXLON
Technology with Passion

DISTRIBUÉ PAR / DISTRIBUTED BY:

QNDE 
QUALITY NDE LTD

QUEBEC

164, St-Jean-Baptiste
Mercier, QC J6R 2C2
450-691-9090
info@qn.de.ca



ONTARIO

275, Sheldon Drive, Unit 3
Cambridge, ON N1T 1A3
519-894-9069
nadams@qn.de.ca

ALBERTA

7307, 50 street NW
Edmonton, AB T6B 2J9
587-689-6811
lfields@qn.de.ca

www.qnde.ca

1-800-361-3630

CONTENTS

1	Assembly instructions	2
	1.1 List of tools for the assembly	3
	1.2 How to assemble the 4-legged tube stand.....	3
2	Intended use.....	3
3	Specifications.....	3
4	How to mount the tube head.....	4

1 ASSEMBLY INSTRUCTIONS

Congratulations with your 4-legged tube stand from YXLON international A/S. Please read these assembly and user instructions carefully before assembling the 4-legged tube stand.

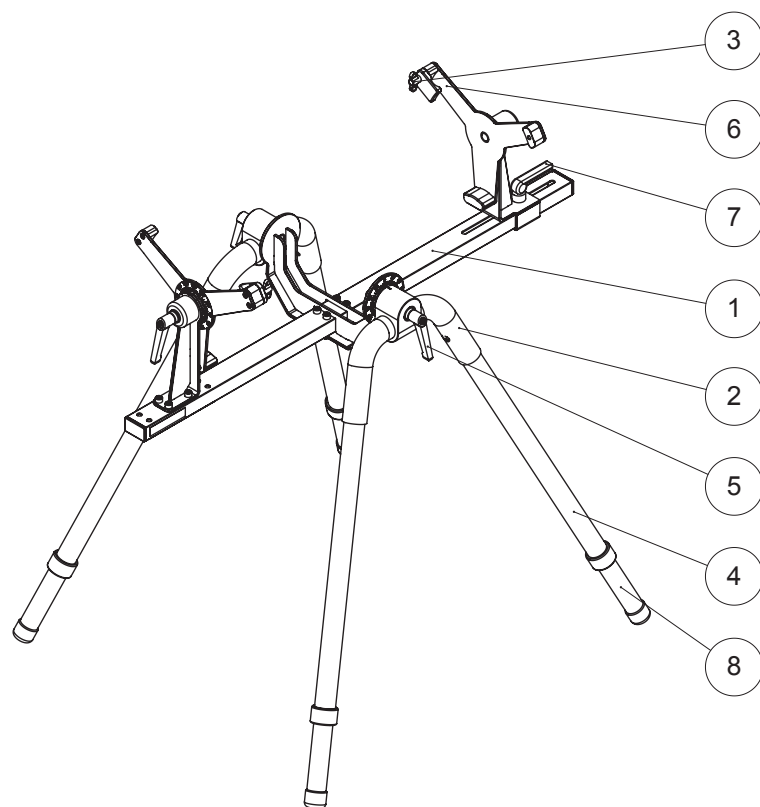

No.	Name	Functionality
1	Centre structure	Adaption to the tube head's size and mounting of the tube head
2	Leg fixtures	Interface for the four telescopic legs
3	Mounting brackets	Locking the tube head to the tube head bracket
4	Telescopic legs	Telescopic legs with adjustable length
5	Adjustment grips for rotation	Grips for rotation and positioning of the tube head
6	Tube head brackets	Rotational brackets for the tube head interface
7	Mounting grip	Mounting grip for mounting the tube head
8	Leg adjustment	Length adjustment points for the legs

1.1 List of tools for the assembly

Use a M6 Allen key.

1.2 How to assemble the 4-legged tube stand

The 4-legged tube stand is delivered divided into a few main parts. Before assembly and use, start by taking out the parts and reading these assembly and user instructions carefully. Keep the wooden box and packaging material for safe transportation between worksites.

- Take out all the parts from the box and carefully remove other packaging materials
- Mount the two leg fixtures (2) on the centre structure (1)
- Use the two adjustment grips (5) to tighten the parts together
- Mount the telescopic legs (4) pair-wise into the leg fixtures (2). When mounted correctly, the safety pin will fit the hole

The 4-legged tube stand is now ready for use.

2 INTENDED USE

The intended use of the 4-legged tube stand is to carry a portable X-ray system from YXLON International A/S. Any other use, or any use together with other equipment than specified by YXLON International A/S, isn't classed as intended use.

- Only use the 4-legged tube stand as intended
- Do not overload the 4-legged tube stand
- The user must ensure that the 4-legged tube stand is placed on a stable surface
- Do not transport or move the 4-legged tube stand when the tube head is mounted
- Do not adjust the height of the legs when the tube head is mounted
- The user must always ensure that all junctions and mounting brackets are present and sufficiently tightened
- Before use, the user must always inspect the 4-legged tube stand for visible damages
- The tube stand should not be used if any visible damages are found

3 SPECIFICATIONS

Weight	15 kg
Max load	40 kg
Min height focal spot – floor Tube head in vertical outermost position	53 cm
Max height focal spot – floor Tube head in vertical outermost position	156 cm
Min height focal spot – floor Tube head in horizontal position	71 cm

Max height focal spot – floor Tube head in horizontal position	124 cm
Required floor space Minimum height	92 cm x 79 cm
Required floor space Maximum height	132 cm x 104 cm

4 HOW TO MOUNT THE TUBE HEAD

Adopt the fixed adjustment on the centre structure to the desired directinal tube head type.
Choose between 3 positions:

Positions	Tube heads
Outermost	SMART EVO 300D, XPO EVO 225D, Y.SMART 300HP, Y.XPO 225
Middle	SMART EVO 200D, SMART EVO 225D, Y.SMART 200, Y.SMART 225
Innermost	SMART EVO 160D, Y.SMART 160E (Rubber hand ring required)

Use a M6 Allen key.

- Adjust and lock the telescopic legs (4, 8) to the desired height
- Open the mounting bracket (3)
- Place the centre structure (1) in the vertical position with the adjustable end upwards
- Push and lock the adjustable end to the uppermost position (6)
- Lock the centre bar by tightening the two adjustment grips for rotation (5)
- Turn the two revolving tube head brackets (6) until the mounting bracket (3) are placed opposite the centre bar
- Lift the tube head and place it in accordance with the orientation of the tube head brackets (6)
- Release the adjustable tube head brackets (6) and squeeze it into position around the hand ring
- Tighten the two mounting brackets (3)

The tube head is correctly mounted in the 4-legged tube stand and ready for manipulation.

QUALITY

You need equipment you can rely on, day in day out. Built in Denmark to stringent specifications with the highest quality components, our products are both built to last and operate accurately even under the harshest situations. For us, the highest priority is placed on quality: the quality of our X-ray equipment and, as a result, the quality of your products.

TRUST

You work in unpredictable challenging environments and sometimes things don't go as planned. That's when it's good to know that we've got your back. With our comprehensive support and local service and repair network, you can trust us to keep downtime to a minimum.

EXPERIENCE

With YXLON Copenhagen, you're in good company. As the leading global provider of X-ray inspection equipment for industrial applications, we have the right solution to match nearly every application. Our years of experience have enabled us to gain the confidence and trust of some of the world's top companies in a wide range of demanding business areas. We'd like to think that your company is next.

DISTRIBUÉ PAR / DISTRIBUTED BY:



QUEBEC

164, St-Jean-Baptiste
Mercier, QC J6R 2C2
450-691-9090
info@qn.de.ca

ONTARIO

275, Sheldon Drive, Unit 3
Cambridge, ON N1T 1A3
519-894-9069
nadams@qn.de.ca

ALBERTA

7307, 50 street NW
Edmonton, AB T6B 2J9
587-689-6811
lfields@qn.de.ca

www.qn.de.ca

1-800-361-3630

